

**DAVE FERREY
CONSTRUCTION
CUSTOM HOMES
570-256-3278**

Carriage Hill

2,372 sq. ft.
Oaks Collection



Specifications

Total Living Area:	2,372 sq.ft.
Main Living Area:	1,752 sq.ft.
Upper Living Area:	620 sq.ft.
Garage area:	714 sq.ft.
House Width:	64'
House Depth:	53'
Bedrooms:	3
Baths:	2 1/2
Max Ridge Height:	29'6
Primary Roof Pitch:	12/12
Porch:	72 sq.ft.
Deck:	124 sq.ft.
Formal Dining Room:	Yes
Fireplace:	Yes
1st Floor Master:	Yes
Main Ceiling Height:	8'
Upper Ceiling Height:	8'
Vaulted Ceiling:	Yes
Foundation:	B, C, S
Walls:	2x4
Plan:	20368

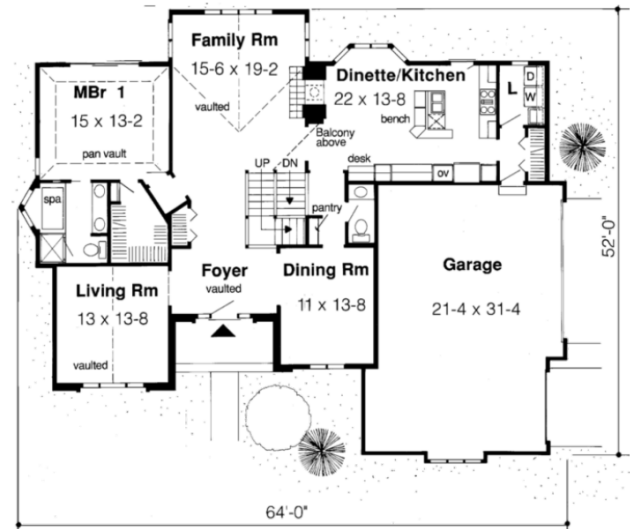
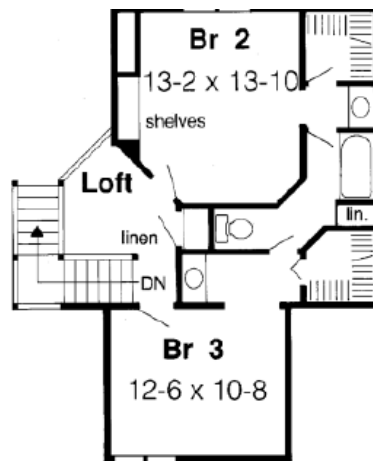

Classic Lofty Views

If open space suits your taste, here's a sturdy stucco classic that fits the bill with style. The vaulted-foyer is flanked by a soaring living room with expansive arched window, and a formal dining room. Step up the stairs to the loft for a great view of the fireplace in the family room, leading to the spacious kitchen/dinette. While upstairs, notice the two bedrooms with walk-in closets and adjoining bath. The master suite, with its garden spa, private deck access and walk-in closet on the first floor, is just off the foyer.

Photos or renderings will vary from actual plan.

Oaks Home Collection

**Your Oaks home package will include these basic package components:
(Upgrades and substitutions are available on most components)**

Exterior Shell Package

- Blueprints
- Treated sill plates
- Floor joists and rim joists
- 3/4" plywood floor
- 2"x6" wall framing
- OSB wall sheathing
- Building wrap
- Roof rafters or trusses per plan
- OSB roof sheathing
- Fiberglass roofing shingles
- Aluminum drip edge
- Roofing felt
- Roof ventilation
- Insulated windows
- Exterior trim
- Fiber cement siding
- Fiber cement soffit & fascia
- Fiber cement trim
- Gutters and downspouts
- Insulated exterior doors
- Exterior locksets
- Nails and hardware

Interior Package

- R-19 wall insulation
- R-30 ceiling insulation
- Insulation baffles
- Drywall,
- Drywall finishing materials
- Colonist primed interior doors
- 2 1/4" fingerjoint Colonial casing
- 3 1/4" fingerjoint Colonial base
- Shelving & closet rods
- Privacy and passage locks
- Fasteners and adhesives

Kitchen and Bath Packages

- Timberlake Tahoe Kitchen cabinets
- Post-formed laminated countertop
- Stainless steel double bowl sink
- Timberlake Tahoe Bathroom vanities
- Cultured marble vanity tops
- Bath cabinets & mirrors
- Tub/shower units



The following materials and services are not supplied by Dave Ferry Construction:

- Foundation
- Steel beams or columns
- Brick
- Stone
- Stucco
- Plumbing
- HVAC
- Electric
- Finish flooring

To order plans call 570-256-3278, or contact Dave Ferrey Construction.