

**DAVE FERREY
CONSTRUCTION
CUSTOM HOMES
570-256-3278**

Clarissa

1,686 sq. ft.
Oaks Collection

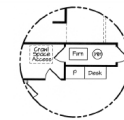

Slab/Crawl Space Option

Specifications

| | | | |
|---------------------|--------------|----------------------|-----------|
| Total Living Area: | 1,686 sq.ft. | Porch: | 96 sq ft |
| Garage area: | 484 sq.ft. | Deck: | 309 sq ft |
| House Width: | 61' | Formal Dining: | Yes |
| House Depth: | 54' | Fireplace: | Yes |
| Bedrooms: | 3 | Main Ceiling Height: | 8' |
| Full Baths: | 2 | Foundation: | B, C, S |
| Max Ridge Height: | 23' | Walls: | 2x6 |
| Primary Roof Pitch: | 8/12 | Plan: | 34029 |

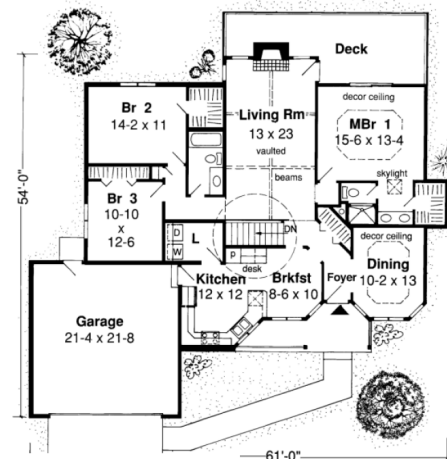

Rising Status

This is a highly sophisticated 1,686 sq. ft. layout. Features include a covered front porch, stylish foyer, and impressive ceiling treatments throughout. The showcase kitchen brims with natural light. More plusses include planning desk, breakfast area, and handy laundry area. A beam and vaulted living room adds dizzying dimension. Family can gather at the fireplace or outdoors on the back deck. The mainfloor master bedroom is charmed by a special ceiling, deck entry, and walk-in closet and sky-lit master bath. Bedroom #2 has its own walk-in, and #3 has a wall-length closet.

Photos or renderings will vary from actual plan.

Oaks Home Collection

**Your Oaks home package will include these basic package components:
(Upgrades and substitutions are available on most components)**

Exterior Shell Package

- Blueprints
- Treated sill plates
- Floor joists and rim joists
- 3/4" plywood floor
- 2"x6" wall framing
- OSB wall sheathing
- Building wrap
- Roof rafters or trusses per plan
- OSB roof sheathing
- Fiberglass roofing shingles
- Aluminum drip edge
- Roofing felt
- Roof ventilation
- Insulated windows
- Exterior trim
- Fiber cement siding
- Fiber cement soffit & fascia
- Fiber cement trim
- Gutters and downspouts
- Insulated exterior doors
- Exterior locksets
- Nails and hardware

Interior Package

- R-19 wall insulation
- R-30 ceiling insulation
- Insulation baffles
- Drywall,
- Drywall finishing materials
- Colonist primed interior doors
- 2 1/4" fingerjoint Colonial casing
- 3 1/4" fingerjoint Colonial base
- Shelving & closet rods
- Privacy and passage locks
- Fasteners and adhesives

Kitchen and Bath Packages

- Timberlake Tahoe Kitchen cabinets
- Post-formed laminated countertop
- Stainless steel double bowl sink
- Timberlake Tahoe Bathroom vanities
- Cultured marble vanity tops
- Bath cabinets & mirrors
- Tub/shower units



The following materials and services are not supplied by Dave Ferry Construction:

- Foundation
- Steel beams or columns
- Brick
- Stone
- Stucco
- Plumbing
- HVAC
- Electric
- Finish flooring

To order plans call 570-256-3278, or contact Dave Ferrey Construction.